

# SERIES 50SN ECONOMICAL ULTRA - PURE SANITARY BALL VALVES



**FIG. 50SN-10**  
Tri-Clamp Ends



**FIG. 50SN-20**  
Tube OD Ends

## DESIGN ADVANTAGES

### True Tube Full Port Design:

There are no dead space in the through path, eliminates trap areas and reduces pressure drop.

### In-Line Welding

Tube O.D. butt weld ends allows in-line welding without disassembly.

### Blow-Out Proof Stem

Prevents stem from blowing-out, for maximum operating safety

### Flush and Drain (CIP/SIP) Capability

Bosses are provided in the end caps for both flush and drain capability in applications where material can become trapped in the body cavity.

### Easy in-Line Maintenance

3-piece body swing-out design allows easy In-Line maintenance

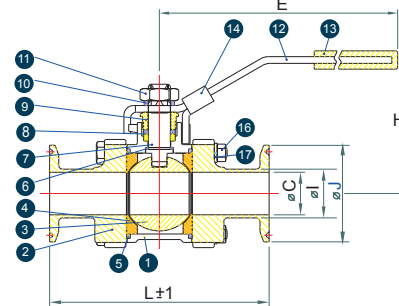
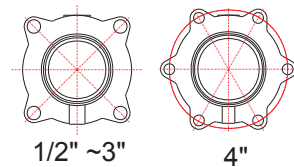
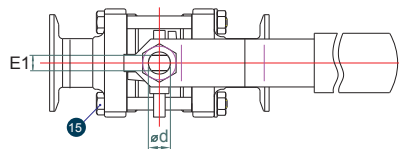

PS: 4" Handle washer

NO.	PART NAME	MATERIAL	Q'TY
1	Body	CF8M	1
2	End Cap	CF3M	2
3	Ball	SUS316/CF8M	1
4	Seat	PTFE	2
5	Joint Gasket	PTFE	2
6	Stem Seal	PTFE	1
7	Stem	SS316	1
8	Stem Packing	PTFE	1Set
9	Gland Nut	SUS 304	1
10	Stem Washer	SUS 304	1
11	Stem Nut	SUS 304	1
12	Handle	SUS 304	1
13	Handle Sleeve	VINYL	1
14	Locking Device	SUS 304	1
15	Bolt	SUS 304	*
16	Bolt Nut	SUS 304	#
17	Bolt Washer	SUS 304	#
18	Handle Washer	SUS 304	@

\* 4pcs:1/2"~3"

6pcs: 4"

#1/2"~2"-4pcs, 2 1/2"~3"-8pcs, 4"-12pcs

@ for 4"-1pc.

SEAT: PTFE or RPTFE  
Pressure Vs. Temperature Chart

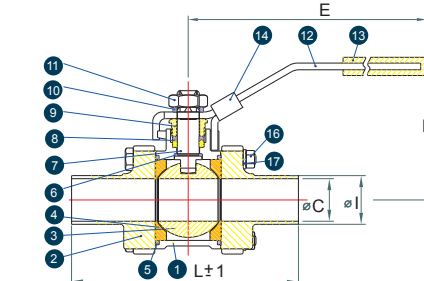
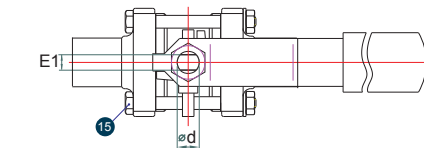
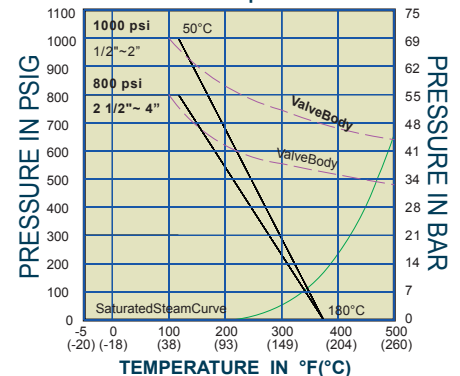

## BREAKAWAY TORQUE(DEGREASED)

SIZE	SERIES 50SN Standard Seat		SERIES 50SN Cavity Filler Seat	
	Nm	Inch-Lb	Nm	Inch-Lb
1/2"	9	81	10	92
3/4"	10	92	12	104
1"	16	138	17	150
1.1/2"	38	334	43	380
2"	46	403	52	461
2.1/2"	98	864	104	921
3"	111	979	117	1037
4"	117	1037	124	1094

## DIMENSIONS (mm)

SIZE	ØC	ØI	ØJ	Ød	H	E	E1	L Clamp	L Tube	Wt.(kg) Clamp	Wt.(kg) Tube
1/2"	9.4	12.7	25.2	9.5	64	132	6.5	89.1	139.8	0.60	0.56
3/4"	15.75	19	25.2	9.5	67	132	6.5	101.6	146	0.80	0.80
1"	22.2	25.4	50.4	11	75	167	8	114.5	158.7	1.19	1.05
1.1/2"	34.9	38.1	50.5	14	90	192	9.7	140.1	190.6	2.60	2.50
2"	47.5	50.8	63.9	14	98	192	9.7	159	216	3.89	3.78
2.1/2"	60.3	63.5	77.4	19	137	252	12	174	247.6	8.12	8.24
3"	73	76.2	90.9	19	147	252	12	193.2	266.8	11.20	11.18
4"	97.4	101.6	118.9	24	175	282	15	226	317.6	19.39	19.37

## SPECIFICATIONS

### Sizes Range:

1/2" - 4"

### End connections:

Tri-Clamp  
Tube OD

### Pressure Rating:

1000 PSI: 1/2"~2"  
800 PSI: 2 1/2"~4"

### Valve Material:

ASTM A351-CF8M

### Ball:

SS316 to ASTM A351-CF8M

### Stem:

SS316

### Seat Materials:

PTFE  
R-PTFE  
TFM 1600  
UHMWPE  
Cavity-filled PTFE  
Cavity-filled R-PTFE  
50% SS+PTFE  
Cavity filled TFM1600

### Internal Parts Finish:

Standard finish on wetted parts  
15 - 20 Ra or 240 Grit